

PP 11 B
Grade 7
Maths Paper 2

Section A

Answer the questions in this section

1.(a)

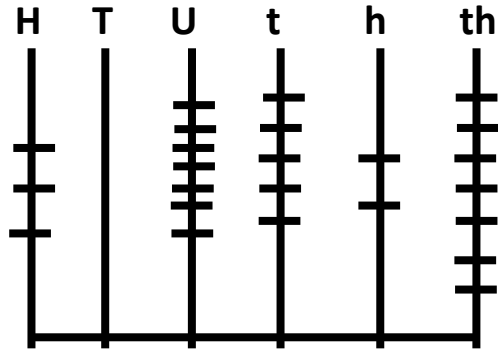

Write down the number shown on the abacus. [1]

(b). Express $\frac{3}{7}$ of fortnight in days. [2]

2.(a) $\frac{18}{24}$ in its lowest terms is..... [2]

(b) Forty thousand and four in figures is..... [1]

(c) What is the value of 5 in 453 708? [1]

3.(a)

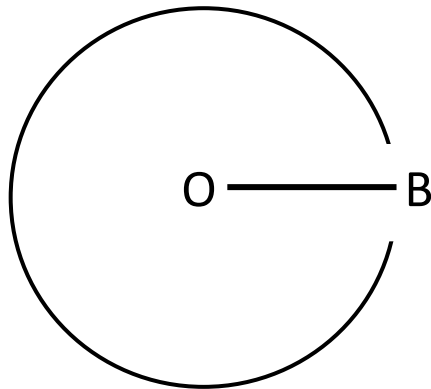

Line OB is a..... [1]

(b) $\frac{1}{2}$ hours - $\frac{1}{3}$ hour = [2]

(c) $90,09 + 0,9$ [1]

4.(a) Calculate the area of this shape..... [2]

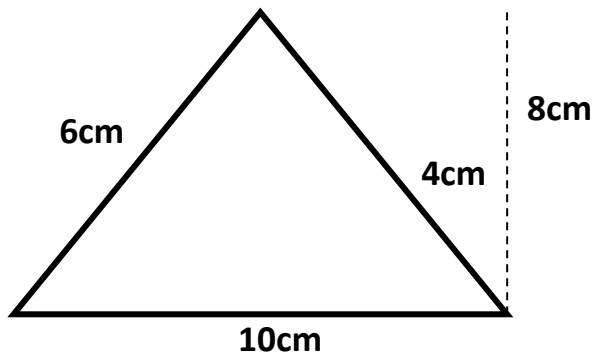

- 5.(a) What is the lowest common multiple(L.c.m) of 4 and 8? [1]
 (b)What is the total of 1089, 6975 and 786? [2]

6. A box of apples is shared between Chipo and Lizzy in the ratio 3:5. If Chipo gets 18 apples, Find the number of apples Lizzy gets [2]

7.

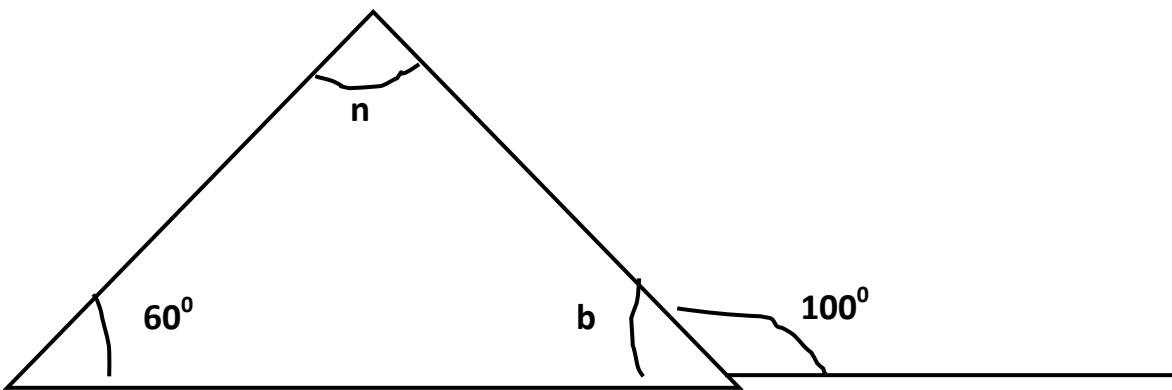

- (a) Calculate the angle b..... [1]
 (b) Find angle n [2]
- 8.(a) A girl added $\frac{3}{8}$ litres of Mazoe orange juice to 500ml of water. Calculate the total volume of the drink. [3]
 (b) LVI in Arabic numerals is..... [1]

Section B [15 MARKS]

Answer any three questions in this section

9. A teacher had 25m roll of cloth. He used 12,28m to make suit and 5,5m to make shorts.
- (a) Find the length left [3]
(b) If he made 4 suits of the same size, Find the length of material used to make the suits [2]

10.

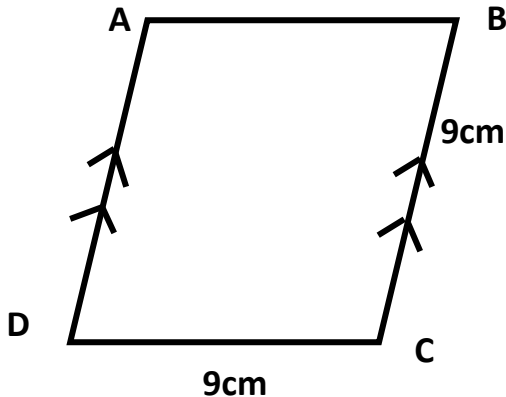

- (a) Name a line parallel to line A-D [1]
(b) Calculate the area of this shape [2]
(c) What is the difference between the area and the perimeter of this shape? [2]
11. 1000 tractors were donated to 30 districts. They shared 75% of them equally and the remainder were given to a co-operative.
- (a). Calculate the number tractors given to each district. [3]
(b). Find the number of tractors given to the co-operative [2]
12. There are 80 dairy cows on a farm. Each cow produces 10 litres of milk daily.
- (a). Calculate the amount of milk produced in fortnight. [2]
(b). 2 litres of milk is sold at \$1,56. Find the amount the farmer earned in the month of April [3]
13. The diagram below shows the road from the church to the clinic through the school and shops. The road is 15 km long

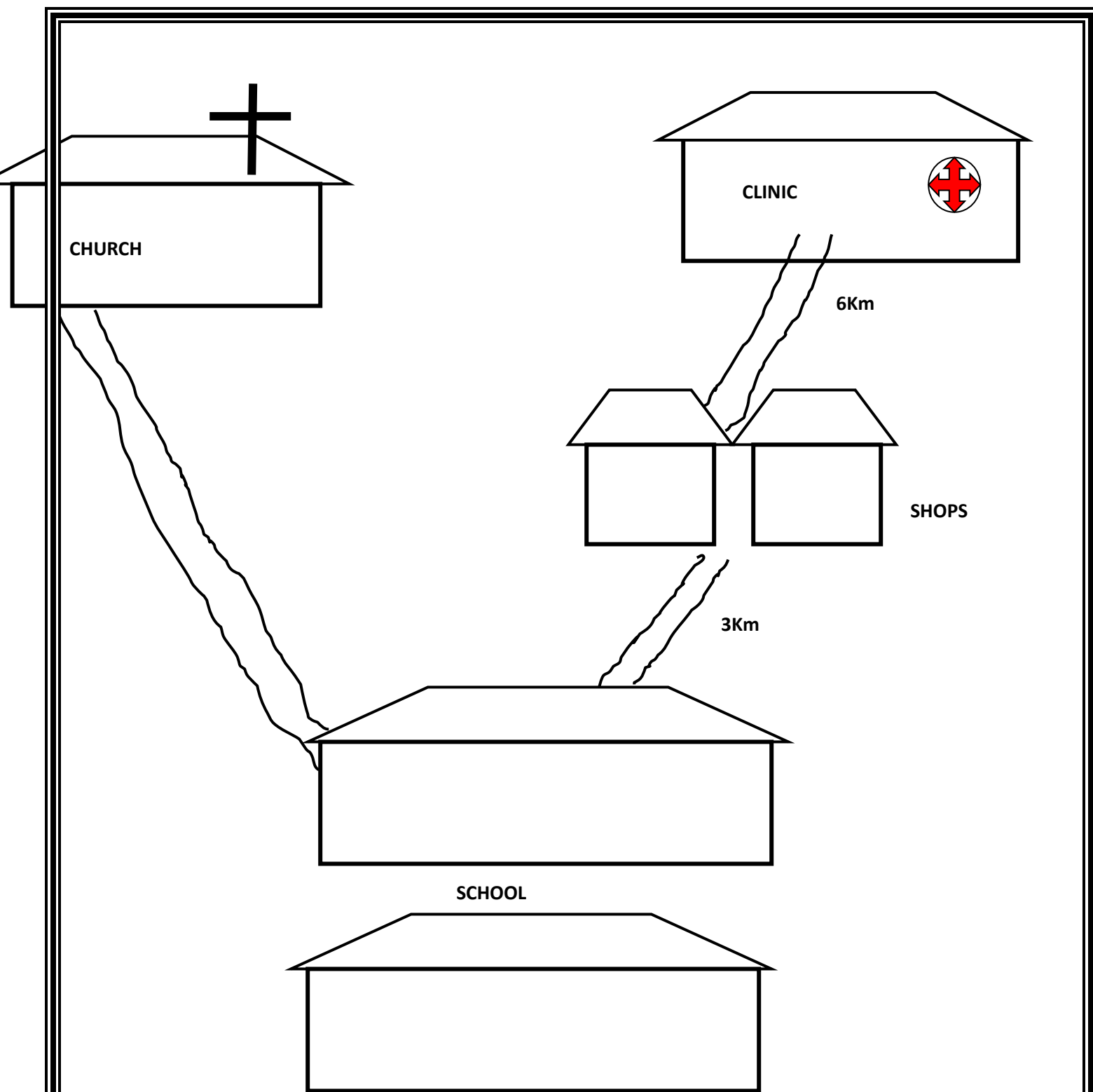

(a). Calculate the distance from the school to the clinic. [1]

(b). Find the distance from the church to the school [1]

(c) John walks to and from the clinic to church through the school and shops for a week. Calculate the distance he walked in that week